

SECTION: 34,35,3,2	TOWNSHIP: 1 South, 2 South	RANGE: 10 West
COUNTY: Tillamook		DATE: 04/06/2023
CORNER DESIGNATION: Section corner common to sections 34 & 35, T1S and sections 2 & 3 T2S, R10W, Willamette Meridian, Tillamook County, Oregon.		(Please check one)
		<input type="checkbox"/> Condition Report Only
		<input type="checkbox"/> Restoration
		<input checked="" type="checkbox"/> Rewitness
		<input type="checkbox"/> Unrecorded
		<input type="checkbox"/> Reset at surface
		<input type="checkbox"/> Referenced Out

Previous Rewitnesses, Restorations and Surveys, etc... Original G.L.O. field notebook 2S 10W pg. 7, 36, and 74; 1S 10W pg. 71 information held in BLM Field Note Volume: OR-R0053 Page: 0106.00 File: orr0053010; Hays Book F, Page 72 (1887); Book 1, Page 5 (1887); P-6, Page 54 and 55 (1925); Rewitness Book 5, Page 59 (1965); B-555 (1968); Rewitness Card #434 (1975); A-5710 (1988); Book 7, Page 457 (2008); B-3917 (2018).

History, condition, and sources: In ±1857 under G.L.O. contract corner section post was set, and 4 bearing trees were established. In 1887 Hays (HAYS F pg. 72), (Bk. 1, pg. 5) renewed the post and added 4 bearing trees. In 1965 (Bk. 5 pg. 59) 1 ¼" Iron Pipe was found, (probably set by W.E. Anderson on map B-45, see book P5 pg. 52) and 4 new bearing trees were established. In 1976 (Rewitness Card #434) Tillamook County Surveyor Office set a 2" Iron Pipe with a 3" Brass Cap in 10" tile and cement at position of found 1 ¼" Iron Pipe and added a Hat Section Post with corner tag. In 2008 (Bk. 7 pg. 457) Tillamook County Surveyor Office set a new Hat Section Post with a yellow metal location tag 1.5' East of corner monument. The previous Hat Section Post and tag were damaged by falling trees. Four new bearing trees were established. In 2023 (Field Bk. MR 14 pg. 42) Tillamook County Surveyor Office visited the section corner and found a 3" Tillamook County Brass Cap (stamped "T1S R10W S34 S35 S3 S2 T2S R10W 1976 RS 287") in concrete as shown hereon in good condition.

Found: (Rewitness Bk. 7 pg.457) 22" Hemlock S68°E 24.0'. Now 6' tall stump with scribing, yellow metal location tag, and nail with aluminum washer stamped "TILL.CO.SURVEYOR".

Found: (Rewitness Bk. 7 pg. 457) 20" Hemlock S15°W 11.2'. Now 2' tall stump with scribing, and nail with aluminum washer stamped "TILL.CO.SURVEYOR".

Found: (Rewitness Bk. 7 pg. 457) 19" Hemlock N14°E 21.7'. Now 5' tall stump with scribing, and nail with aluminum washer stamped "TILL.CO.SURVEYOR".

Found: (Rewitness Bk. 7 pg. 457) 19" Hemlock N86°W 10.6'. Now 6' tall stump with scribing, yellow metal location tag, and nail with aluminum washer stamped "TILL.CO.SURVEYOR".

Found: (Rewitness Bk. 7 pg. 457) Hat Section Post with yellow metal location tag 1.5' East.

New accessories set:

The Monument was tied conventionally using G.P.S. established control. The coordinates have been converted and are provided here in WGS 84, Latitude and Longitude.

Latitude: 45° 26' 04.50"

Longitude: - 123° 53' 10.21"

Pictures of Found Monuments:



Location: ± 700' from the intersection of Hwy. 131 and Fraser Road to access road #100. ± .80 miles to road #107. ± 500 feet North and ± 50 feet East of road #107 to Section Corner.

Tillamook County Surveyor office: 1510 3rd Street Suite C, Tillamook, OR. 97141

Party Chief: Travis Porter, Survey Supervisor

Witnesses: Michael Rice, PLS 86926, Tillamook County Surveyor
Kael Poklikuha, Survey Technician

Notes: Digital images taken of monument and accessories.

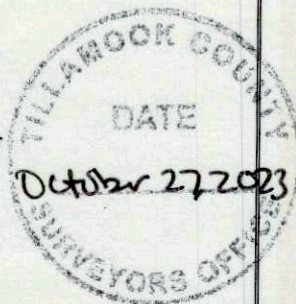

SURVEYOR'S SEAL

REGISTERED
PROFESSIONAL
LAND SURVEYOR

Michael R. Rice

OREGON
DECEMBER 11, 2012
MICHAEL R. RICE
86926

RENEWAL 12-31-2024